

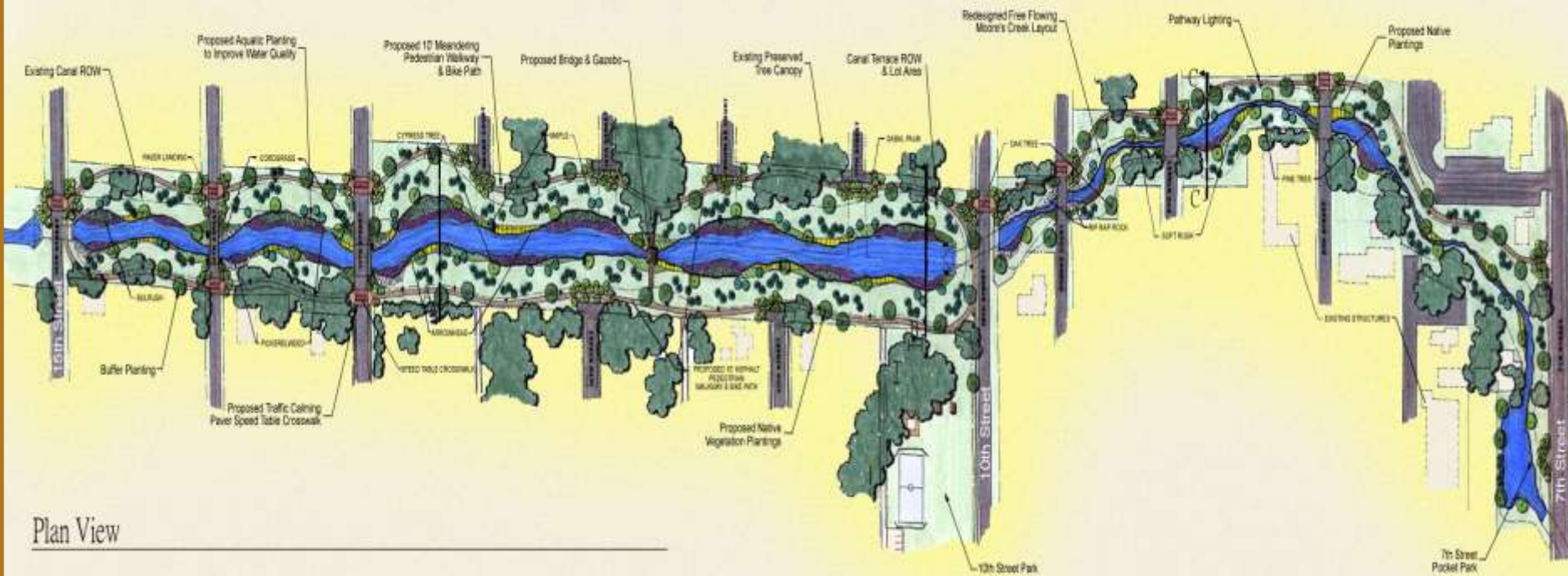

FUNDING GREENSPACE PROJECTS



MOORE'S CREEK LINEAR PARK



Plan View

**KEY TO SUCCESS:
HOW DOES THE PROJECT FIT IN THE
COMMUNITY?**

MOORE'S CREEK LINEAR PARK

+ What is it?

+ What could it be?

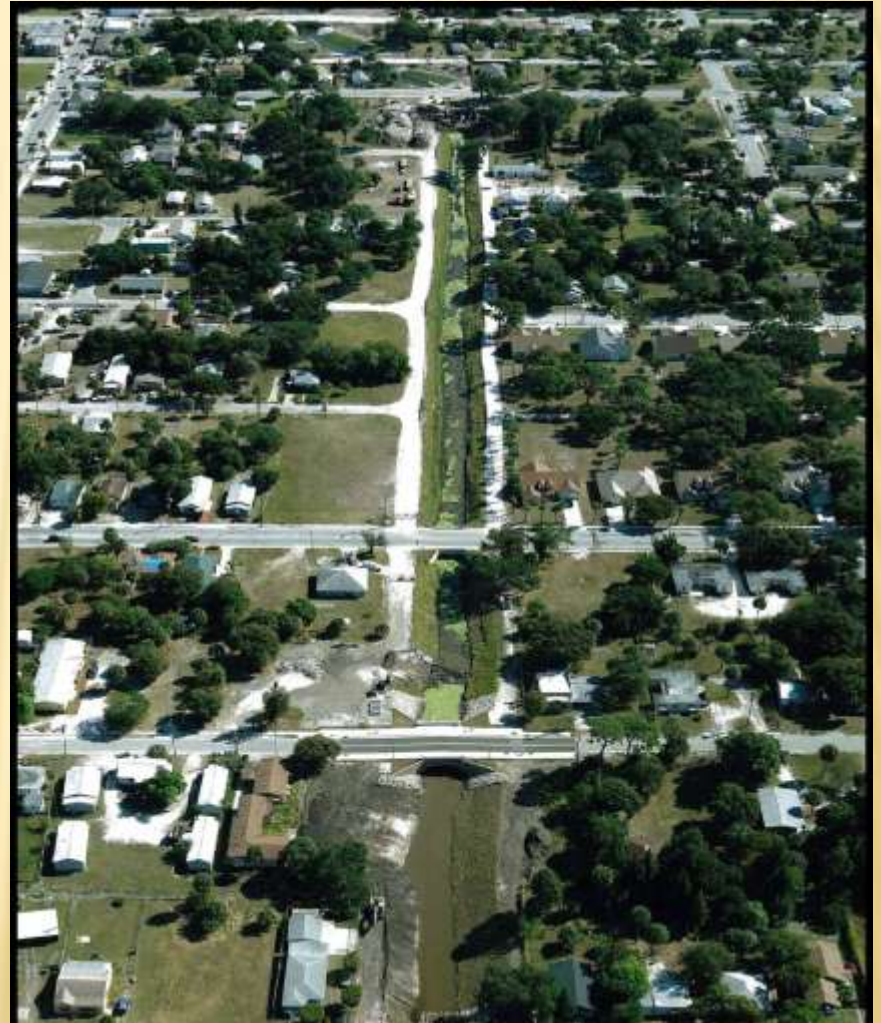

**FLOOD CONTROL
STRUCTURE**

**WATER QUALITY
TREATMENT FACILITY**

PARK

**NEIGHBORHOOD
HOUSING
DEVELOPMENT
PROJECT**

**TRANSPORTATION
CENTER**

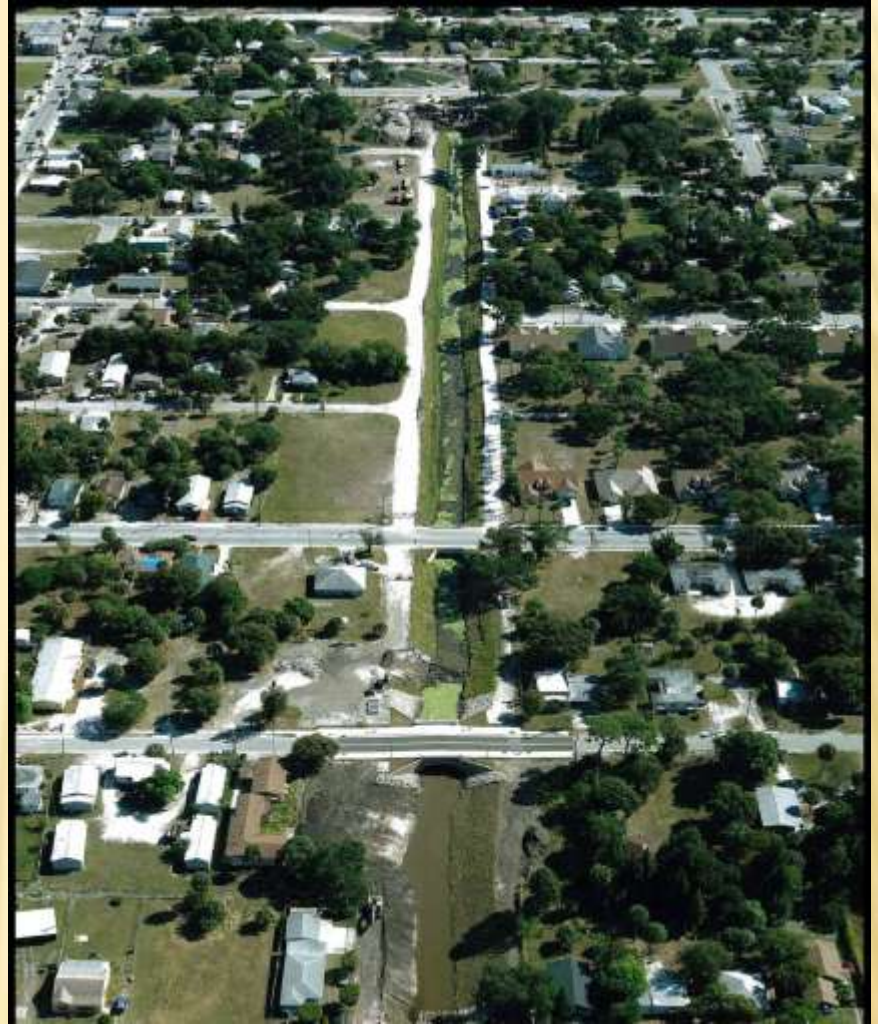

WHAT COULD IT BE?

MOORE'S CREEK LINEAR PARK

- + Agencies that care about FLOODING
 - × FEMA – Hazard Mitigation Programs
 - × Natural Resources Conservation Service
 - × HUD (Public Infrastructure – CDBG)
 - × USDA (Rural Areas)

- + Agencies that funded Moore's Creek
 - × FEMA: \$3,000,000 through the Section 404 Hazard Mitigation Grant Program.



MOORE'S CREEK LINEAR PARK

+ Agencies that care about WATER QUALITY

- × EPA – Section 319 program, TMDL
- × DEP – SRF (Revolving Loan Fund)
- × Water Management Districts

+ Agencies that funded Moore's Creek

- × EPA'S Section 319: \$300,000
- × St. John's WMD: \$50,000 (design costs)
- × South Florida WMD:\$1,700,000

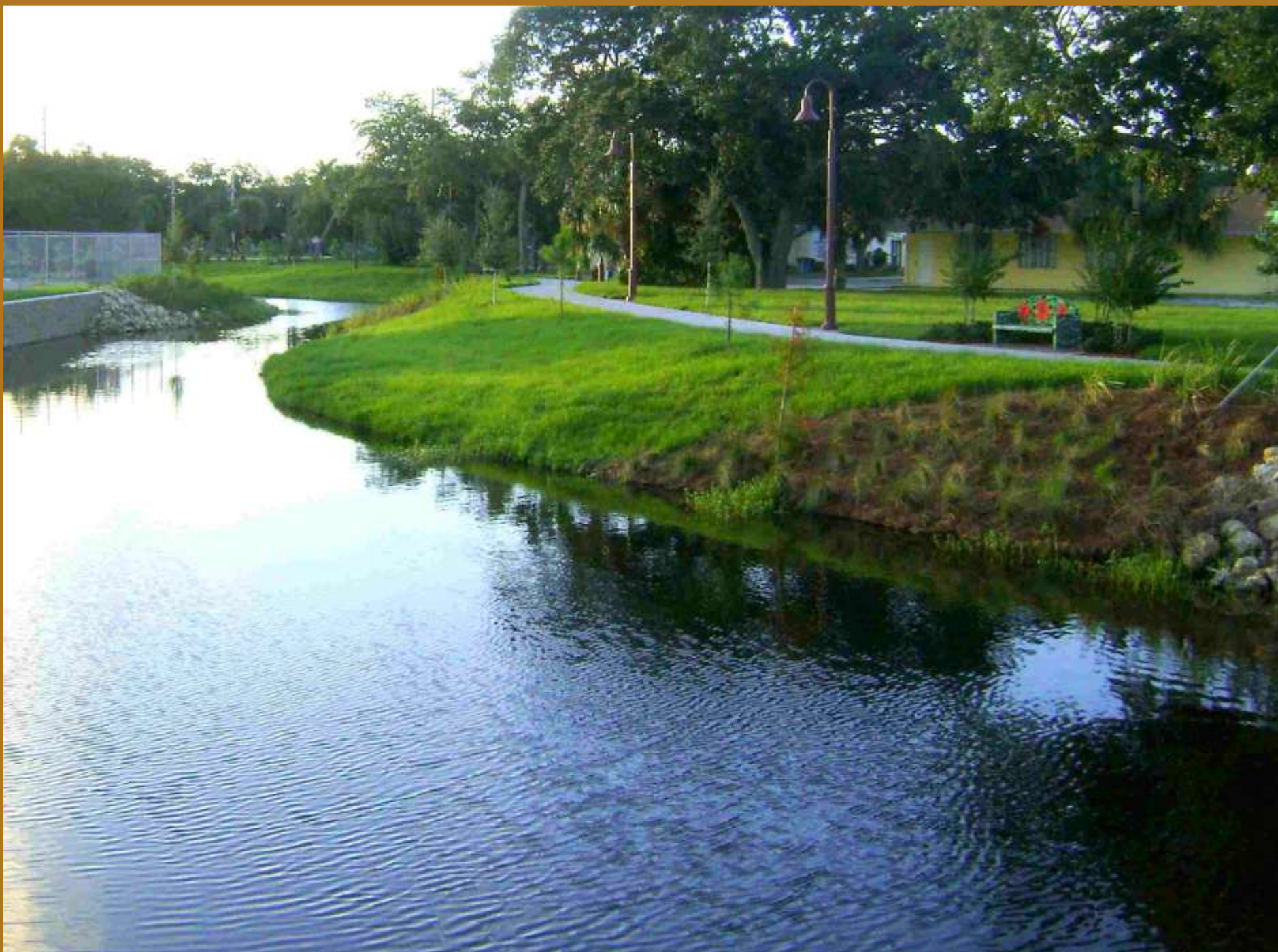





Pre-Constructon - 9th Street Bridge and Dundas Ct. Bridge

Before and After



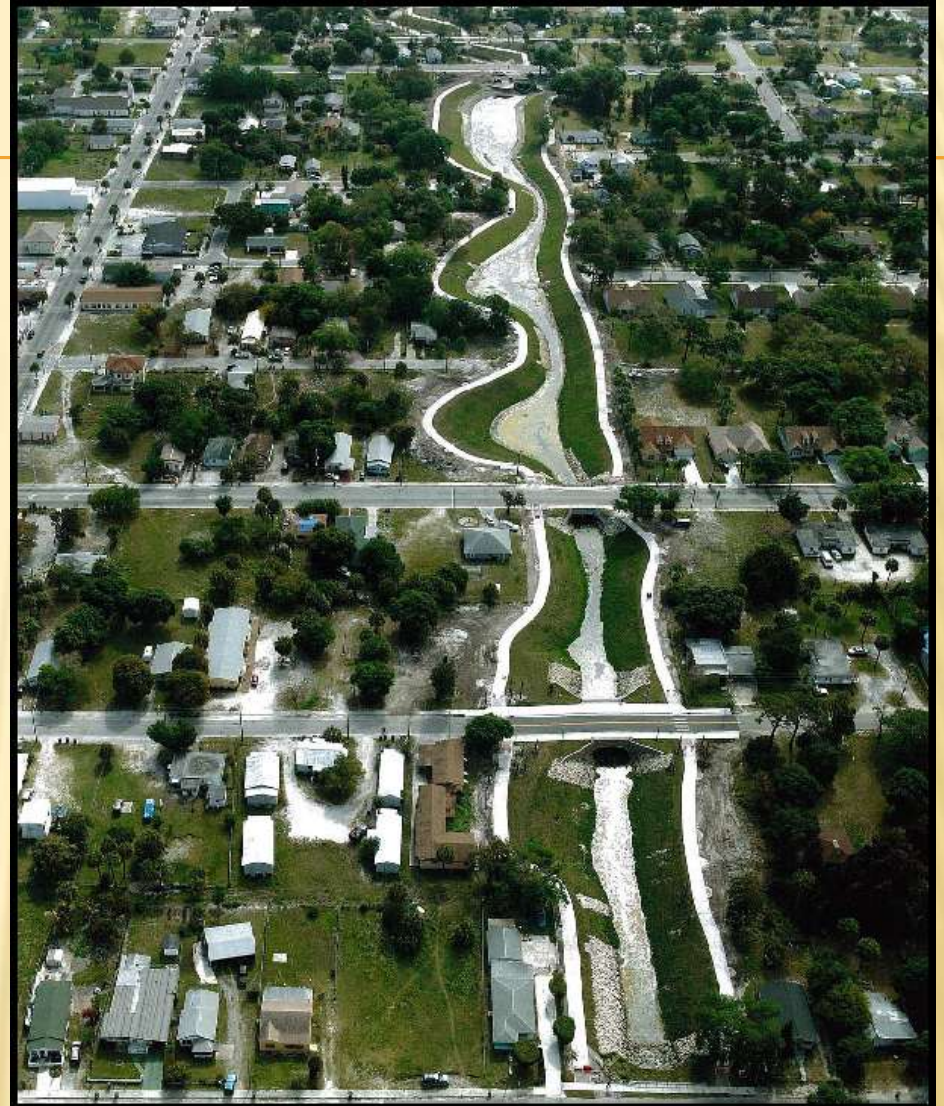

**Moore's Creek Linear Park - (View facing east from
15th Street to 7th Street)**

**Before and
After**

MOORE'S CREEK LINEAR PARK

- + Agencies that care about PARKS
 - × DEP – FRDAP and LWCF Programs
 - × DCA – Florida Communities Trust Program
 - × FHWA – Scenic Byways Program
 - × FIND – Florida Inland Navigation District

- + Agencies that funded Moore's Creek
 - × FRDAP Program: \$400,000
 - × Florida Communities Trust: \$2,000,000





MOORE'S CREEK LINEAR PARK

- + Agencies that care about HOUSING
 - × HUD
 - × DCA
 - × EPA / FHWA

- + Agencies that funded Moore's Creek
 - × DCA – State Disaster Housing Funds:
\$2,000,000 (Oaks of Moore's Creek)

A blue sign for a housing development. The sign features the 'The Sunnier City' logo on the left and a 'New Home' logo on the right. The main text reads 'COMING SOON!' and '"THE OAKS" AT MOORE'S CREEK HOUSING DEVELOPMENT'. Below this, it says 'All Plans Available by Appointment Only'. There are three columns of text providing details about the development, including the number of units, the location, and the contact information for the developer.

THE SUNNIER CITY

COMING SOON!

"THE OAKS" AT MOORE'S CREEK HOUSING DEVELOPMENT

All Plans Available by Appointment Only

1,200 Units
1,200 Units Available
4,000 sq. ft. per unit
200 sq. ft. of outdoor space per unit

5000 North County
4000 North County
1000 North County
1000 North County

One Year Home
100 sq. ft. of
100 sq. ft. of
100 sq. ft. of
100 sq. ft. of

For Information Call 772-396-2200



MOORE'S CREEK LINEAR PARK

+ Agencies that care about TRANSPORTATION

- × FHWA

- × FDOT

- × HUD/EPA

+ Agencies that funded Moore's Creek

- × FHWA/FDOT: \$4,000,000

(Bus Transportation Center)

HOW DID WE PAY FOR IT?

Land Acquisition Phase (2006 – 2007)

+ CRA funds:	\$2,450,000
+ Florida Communities Trust:	\$2,000,000
+ SFWMD:	\$ 350,000
+ <u>FRDAP:</u>	<u>\$ 200,000</u>
+ Total Cost:	\$5,000,000

50% Grant Funded



HOW DID WE PAY FOR IT?

+ Construction (2009–2010)

+ CRA/SMU funds: \$2,600,000

+ FEMA: \$3,000,000

+ South FL WMD: \$1,400,000

+ FRDAP: \$ 200,000

+ Total Cost: \$7,200,000

64% Grant Funded

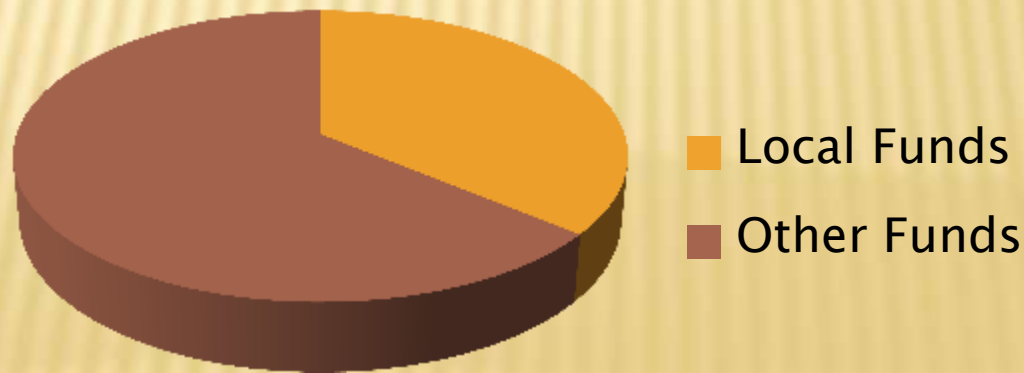



Moore's Creek Linear Park

12th St. looking west to 13th St.

September 2010